

Feature

150# WSP / 600# WOG
 Lead free brass body
 Full port
 Adjustable packing
 FNPT x FNPT
 Threaded ends (ASME B1.20.1-NPT)
 Blow-out proof stem
 Chrome plated ball
 Virgin PTFE seats
 MSS-SP-110
 CSA certified ANSI Z21.15/CSA 9.1 - 1/2 psi (1/4" - 3")
 CSA ΔC (1/4" - 2")
 CSA certified CGA CR91.002 - 5G (5 psi) (1/4" - 2")
 CSA certified ASME B16.44 - 5G (5 psi) (1/4" - 3")
 CSA certified CSA 3.16 -125 psi (1/4" - 2")
 UL approved (600 psi for 1/4" - 1" and 300 psi for 1 1/4" - 2")
 UL Category VQGU (Trim and Drain Valve)
 UL Categories MHKZ-YQNZ-YRBX-YRPV-YSDT
 (Gas Shut-off Valve)
 FM approved (1/4" - 2") class number 1140
 CSA certified ASME A112.4.14 /CSA B125.14 (1/4 - 2")
 CSA certified IAPMO / ANSI Z1157 (1/4" - 2")
 AB1953, NSF/ANSI 61 & 372 certified



Meet BAA requirement

Pressure/ Temperature rating	
600 psi from 15 °F to 160 °F	150 psi max. at 366 °F

Material

	Part	Material	Specification
1	Body	Lead Free Brass	ASTM B927 C27450
2	End piece	Lead Free Brass	ASTM B927 C27450
3	Ball	Lead Free Brass / Cr plated	ASTM B927 C27450
4	Seat	PTFE	PTFE
5	Stem	Lead Free Brass	ASTM B927 C27450
6	Packing	PTFE	PTFE
7	Packing nut	Brass	ASTM B124 C37700
8	Handle	Steel / Geomet® plated	ASTM A36
9	Handle nut	Steel / Zn plated	ASTM A36
10	Valve info	-	-

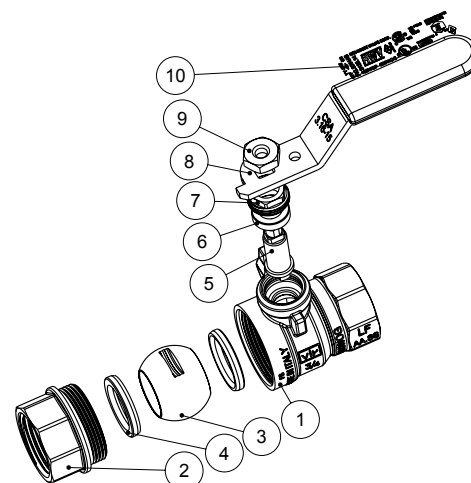

Dimension, Cv, Weight

Size	Φ	A [in]	C [in]	H [in]	L [in]	P [in]	Cv	Wt. [lb]
1/4"	1/4 - 18 NPT	1.72	0.45	1.50	3.15	0.39	8	0.26
3/8"	3/8 - 18 NPT	1.79	0.46	1.50	3.15	0.39	8	0.27
1/2"	1/2 - 14 NPT	2.17	0.61	2.07	3.54	0.50	11	0.44
3/4"	3/4 - 14 NPT	2.40	0.63	2.20	3.54	0.73	26	0.62
1"	1 - 11.5 NPT	2.97	0.75	2.56	4.98	0.98	60	1.13
1 1/4"	1 1/4 - 11.5 NPT	3.31	0.77	2.75	4.98	1.23	103	1.46
1 1/2"	1 1/2 - 11.5 NPT	3.52	0.77	3.14	5.57	1.46	111	2.05
2"	2 - 11.5 NPT	4.11	0.79	3.51	5.57	1.95	353	3.29
2 1/2"	2 1/2 - 8 NPT	5.31	1.06	4.45	7.87	2.44	409	6.28
3"	3 - 8 NPT	6.03	1.14	4.88	11.08	2.94	530	9.24
4"	4 - 8 NPT	7.56	1.20	5.63	11.08	3.94	1200	16.32

