

#### Feature

- 600# WOG
- Brass body
- Full port
- FNPT x Flange
- Threaded end (ASME B1.20.1-NPT)
- Chrome plated ball
- Virgin PTFE seats
- Blow-out proof stem
- 3-piece construction
- Rotating flange design
- ¼-turn operation
- Positive shutoff
- Includes wing handle & bolt kit



#### Material

	Part	Material	Specification
1	Body	Brass	ASTM B283 C37700
2	End piece *	Brass	ASTM B283 C37700
3	End piece	Brass	ASTM B124 C37700
4	Ball	Brass / Cr plated	ASTM B30 C85700
5	Seat	PTFE	PTFE
6	Flange	Brass	ASTM B283 C37700
7	Stem	Brass	ASTM B124 C37700
8	O-ring	FKM	NSF approved
9	Packing ring	PTFE	PTFE
10	Packing nut	Brass	ASTM B124 C37700
11	Handle	Steel / Dacromet® plated	ASTM A36
12	Handle nut	Steel / Zn plated	ASTM A36

\* Only for size 1½" & 2"

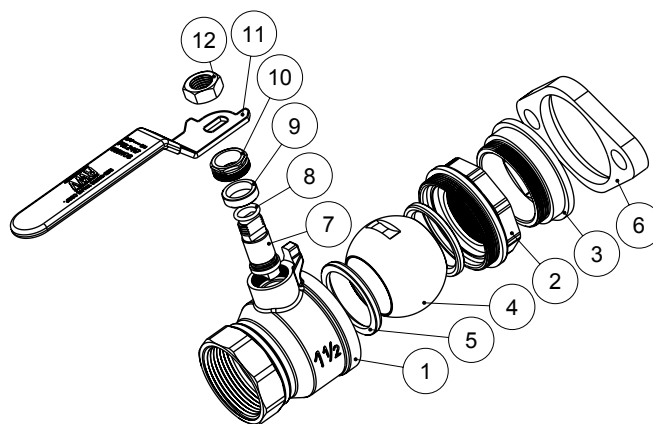

#### Dimension, Weight

Size	ϕ	A [in]	C [in]	H [in]	L [in]	P [in]	Wt. [lb]
¾"	¾ - 14 NPT	2.50	0.63	2.07	3.58	0.73	1.30
1"	1 - 11.5 NPT	2.81	0.75	2.36	4.96	0.94	1.44
1¼"	1¼ - 11.5 NPT	3.32	0.77	2.58	4.96	1.22	1.86
1½"	1½ - 11.5 NPT	3.70	0.77	2.87	5.55	1.46	2.18
2"	2 - 11.5 NPT	4.57	0.79	3.25	5.55	1.95	3.86

