

Lead Free Brass Solder Tankless Water Heater Valve Kit

Feature

- 600# WOG (non-shock)
- Lead free brass construction
- ¼ turn operation
- Adjustable packing
- Blow-out proof stem
- Integral hose end drain/purge valve
- Solder end x FNPT tailpiece
(ASME B1.20.1-NPT)
- Integral relief valve port
- 3420RAB: 200K BTU/hr relief
- 3420TAB: 2.7M BTU/hr relief
- AB1953, NSF/ANSI 61 & 372 certified



- 3401AB: Hot valve operation (red handle)
- 3402AB: Cold valve operation (blue handle)

Material

	Part	Material	Specification
1	Body	Lead Free Brass	C28000
2	Ball	Lead Free Brass / Cr plated	C28000
3	Seat	PTFE	PTFE
4	Fixed end	Lead Free Brass	C28000
5	Stem	Lead Free Brass	C28000
6	Packing ring	PTFE	PTFE
7	Packing nut	Brass	C37700
8	T-handle	Aluminum	ASTM B85
9	Valve info	-	-
10	Handle nut	Steel /Zn plated	ASTM A36
11	Ball	Lead Free Brass / Cr plated	C28000
12	Seat	PTFE	PTFE
13	Fixed end	Lead Free Brass	C28000
14	Drain gasket	EPDM Perox	NSF approved
15	Drain cap	Brass	C37700
16	Cap retainer	Rubber	-
17	Stem	Lead Free Brass	C28000
18	L-handle	Aluminum	ASTM B85
19	Handle screw	Steel /Zn plated	ASTM A36
20	O-ring	EPDM Perox	NSF approved
21	Tailpiece	Lead Free Brass	C28000
22	Union nut	Brass	C37700

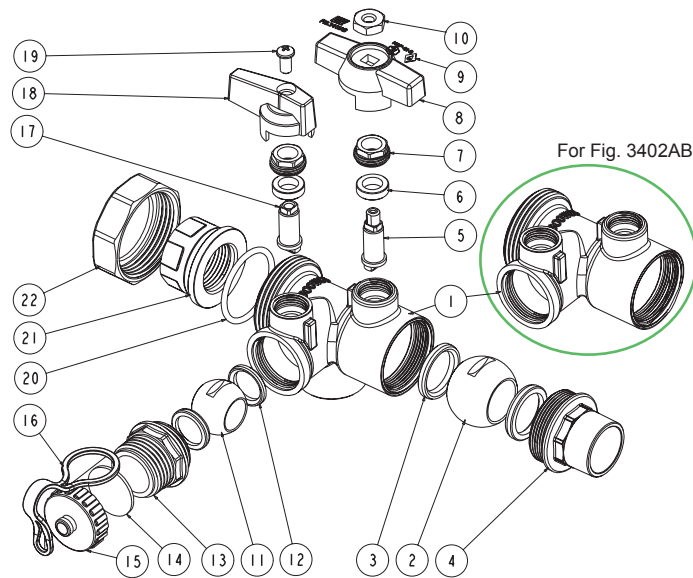

Dimension, Weight

Size	H1 [in]	H2 [in]	H3 [in]	L1 [in]	L2 [in]	L3 [in]	D1 [in]	D2 [in]	D3 [in]	D4 [in]	D5 [in]	Wt.* [lb]
¾"	1.56	1.10	2.66	1.56	2.56	4.55	2.17	0.79	0.88	0.75	0.71	1.80/1.69
1"	1.48	1.18	2.66	1.69	2.76	4.59	3.23	1.12	0.98	0.91	0.73	1.91/1.80

* 3401AB / 3402AB

