

Lead Free Brass EzGRIP Tankless Water Heater Valve Kit

Feature

- 600# WOG (non-shock)
- Lead free brass construction
- ¼ turn operation
- Adjustable packing
- Blow-out proof stem
- Integral hose end drain/purge valve
- EzGRIP end x FNPT tailpiece
(ASME B1.20.1 - NPT)
- Integral relief valve port
- AB1953, NSF/ANSI 61 & 372 certified



- 3451AB: Hot valve operation (red handle)
- 3452AB: Cold valve operation (blue handle)

Material

	Part	Material	Specification
1	Body	Lead Free Brass	C28000
2	Ball	Lead Free Brass / Cr plated	C28000
3	Fixed end	Lead Free Brass	C28000
4	Seat	PTFE	PTFE
5	O-ring	EPDM Perox	NSF approved
6	Cartridge	Resin (POM)	C27453
7	Stem	Lead Free Brass	C28000
8	Packing ring	PTFE	PTFE
9	Packing nut	Brass	C37700
10	T-handle	Aluminum	ASTM B85
11	Nut	Steel /Zn plated	ASTM A36
12	Ball	Lead Free Brass / Cr plated	C28000
13	Seat	PTFE	PTFE
14	Fixed end	Lead Free Brass	C28000
15	Drain gasket	EPDM Perox	NSF approved
16	Drain cap	Brass	C37700
17	Cap retainer	Rubber	-
18	O-ring	EPDM Perox	NSF approved
19	Tailpiece	Lead Free Brass	C28000
20	Union nut	Brass	C37700
21	Stem	Lead Free Brass	C28000
22	L-handle	Aluminum	ASTM B85
23	Handle screw	Steel /Zn plated	ASTM A36
24	Valve info	-	-

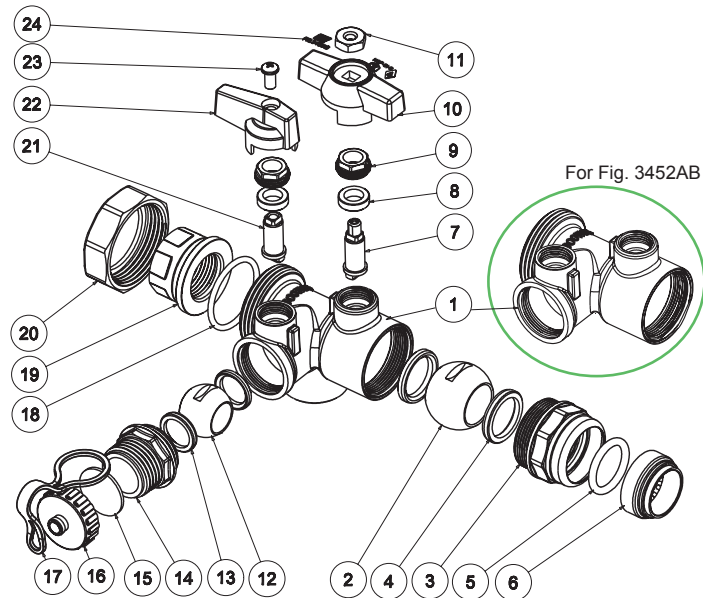

Dimension, Weight

Size	H1 [in]	H2 [in]	H3 [in]	L1 [in]	L2 [in]	L3 [in]	D1 [in]	D2 [in]	D3 [in]	D4 [in]	Wt.* [lb]
¾"	1.56	1.10	2.66	2.09	3.09	5.08	2.17	0.79	0.91	0.71	1.83/1.73

*3451AB / 3452AB

