

#### Feature

- 200# WOG
- Brass body
- Full port
- Adjustable packing
- EzGRIP x EzGRIP
- EzGRIP Push-Fit ends
- Blow-out proof stem
- Works with Copper, CPVC & PEX tubing
- Field adjustable/removable



#### Material

	Part	Material	Specification
1	Packing nut	Brass	ASTM B124 C37700
2	Stem	Brass	ASTM B927 C37700
3	Body	Brass	ASTM B927 C37700
4	End piece	Brass	ASTM B927 C37700
5	Ball	Brass / Cr plated	ASTM B927 C37700
6	O-ring	EPDM Perox	NSF approved
7	Packing ring	PTFE	PTFE
8	Seat	PTFE	PTFE
9	Cartridge	POM Resin	-
10	Handle	Steel / Geomet® plated	ASTM A36
11	Handle nut	Steel / Zn plated	ASTM A36

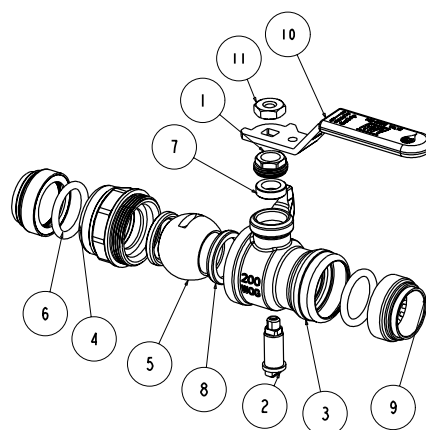

#### Dimension, Weight

	Φ [in]	A [in]	C [in]	H [in]	L [in]	P [in]	Wt. [lb]
1/2"	1/2"	2.58	0.80	2.12	3.60	0.59	0.56
3/4"	3/4"	3.08	0.90	2.25	3.60	0.79	0.80
1"	1"	3.50	1.05	2.55	4.98	0.98	1.18

