

Feature

150# WSP / 600# WOG
Lead free brass body
Full port
Adjustable packing
Solder x Solder
Solder ends (ASME B16.22)
Blow-out proof stem
MSS-SP-110
CSA certified ASME A112.4.14 / CSA B125.14 (1/4" - 2")
CSA certified IAPMO / ANSI Z1157 (1/4" - 2")
AB1953, NSF/ANSI 61 & 372 certified



Meet BAA Requirement

Pressure / Temperature rating	
600 psi from 15 °F to 160 °F	150 psi max. at 366 °F

Connection Working Pressure				
Solder used in joint	Working temp (°F)	Max. working pressure (PSI)		
		3/8" - 1"	1 1/4" - 2"	2 1/2" - 4"
95-5 Tin antimony (ASTM B32 grade 95TA)	100	500	400	300
	150	400	350	275
	200	300	250	200
	250	200	175	150

Material

Part	Material	Specification
1 Body	Lead Free Brass	ASTM B927 C27450
2 End piece	Lead Free Brass	ASTM B927 C27450
3 Ball	Lead Free Brass / Cr plated	ASTM B927 C27450
4 Seat	PTFE	PTFE
5 Stem	Lead Free Brass	ASTM B927 C27450
6 Packing	PTFE	PTFE
7 Packing nut	Brass	ASTM B124 C37700
8 Handle	Steel / Geomet® plated	ASTM A36
9 Handle nut	Steel / Zn plated	ASTM A36
10 Valve info	-	-

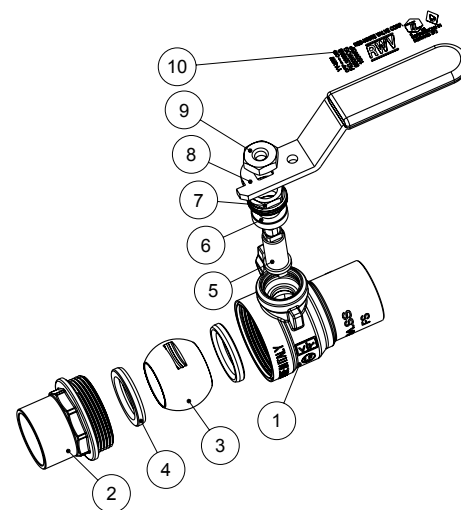

Dimension, Cv, Weight

	Φ [in]	A [in]	C [in]	H [in]	L [in]	P [in]	Cv	Wt. [lb]
1/2"	0.627-0.631	2.20	0.51	2.07	3.54	0.50	11	0.40
3/4"	0.877-0.881	2.86	0.75	2.20	3.54	0.73	26	0.59
1"	1.128-1.131	3.52	0.91	2.56	4.98	0.98	60	1.07
1 1/4"	1.378-1.381	3.83	0.98	2.75	4.98	1.23	103	1.28
1 1/2"	1.628-1.632	4.26	1.09	3.14	5.57	1.46	111	2.11
2"	2.128-2.132	5.33	1.34	3.51	5.57	1.95	353	3.22
2 1/2"	2.628-2.632	6.33	1.50	4.45	7.87	2.44	409	5.66
3"	3.128-3.132	7.29	1.69	4.88	11.08	2.94	530	8.80
4"	4.128-4.133	9.34	2.17	5.63	11.08	3.94	1200	16.76

